

SECTION 1: SITE CONTEXT

Block F2 Urban Open Space Conceptual Plan

PHASES I & II

Phase I: Urban Open Space

- Logan Street Plaza & Overlook to Mid-Block Event Lawn
- Moveable Seating for Outdoor Dining
- Informal Amphitheater
- Accessible Walkway from Logan Street to Mid-Block Event Lawn
- Terraced Gardens with Seating Alcoves

Phase II: Extension Of Urban Open Space

- Event Lawn Extension
- Shaded Pavilion
- Accessible Walkway from Mid-Block Event Lawn to Washington Place
- Terraced Gardens with Seating Alcoves
- Grand Staircase Along the Wylie Avenue Corridor
- Overlooks to Downtown

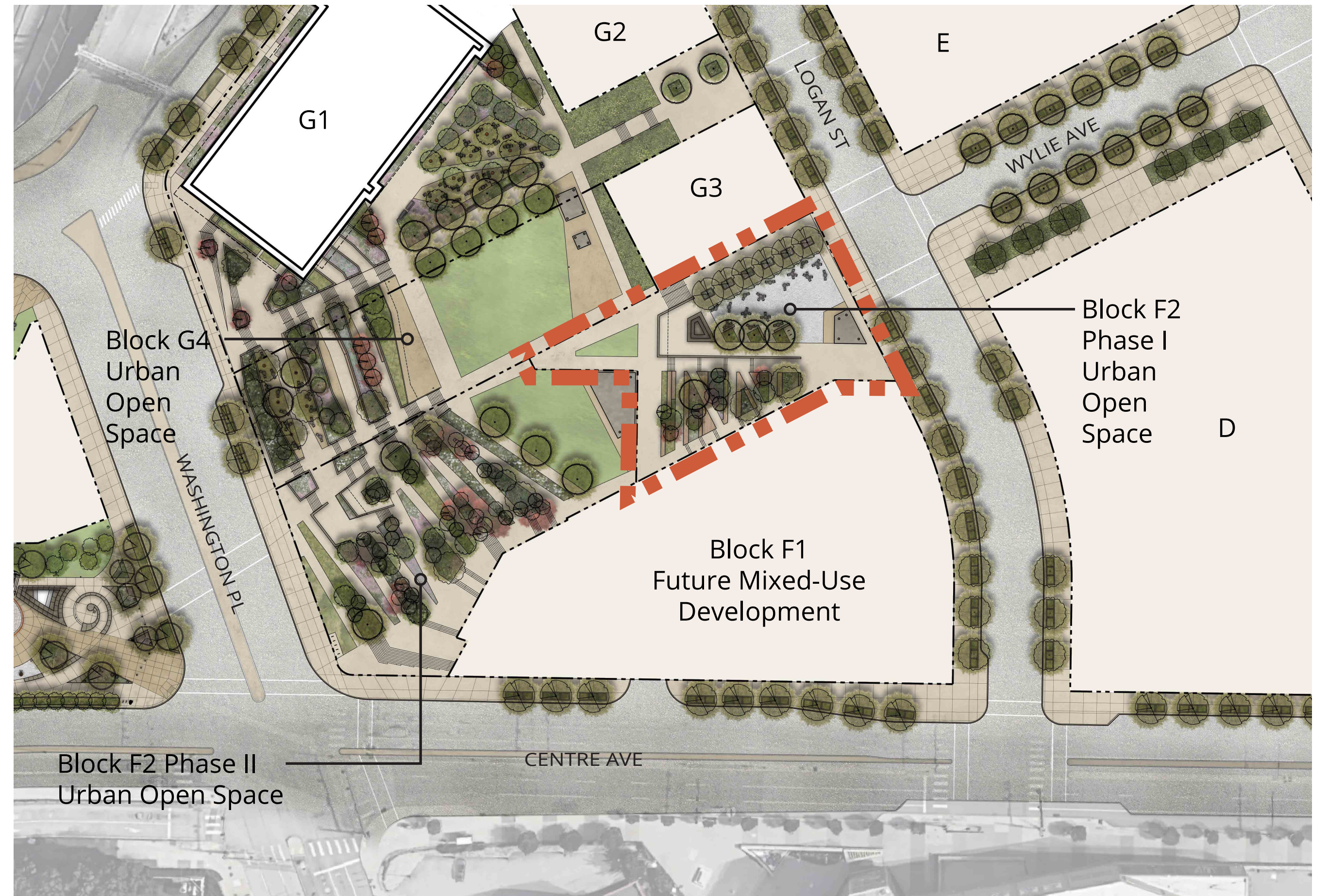

Urban Open Space Site Plan

PHASES I & II

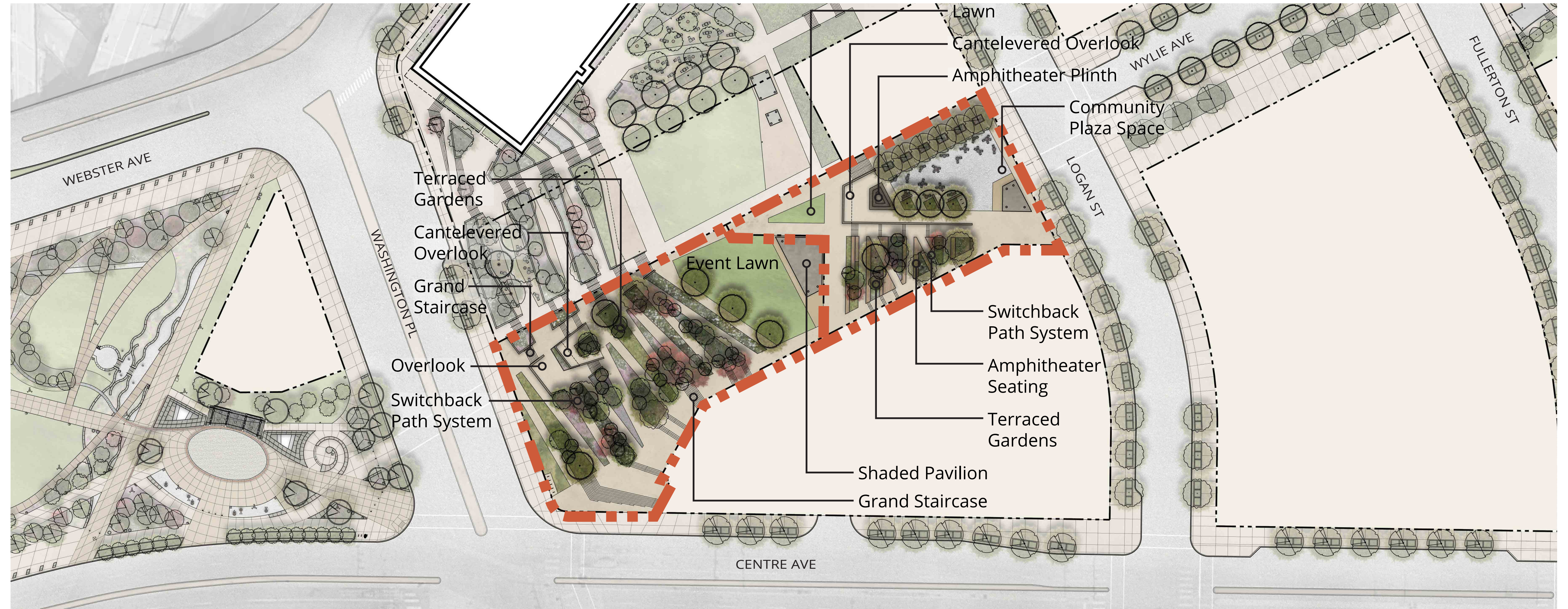

SECTION 2: PROPOSED DESIGN





PERSPECTIVE VIEW LOOKING EAST ALONG THE WYLIE AVE CORRIDOR OF F2 UOS